

Installing Neo Series Hot & Cold Water Bidets (Models 250, 320)

STEP 1

Turn Off the Toilet Tank Water Supply

Shut off the toilet tank water supply. Flush the toilet to empty the tank.

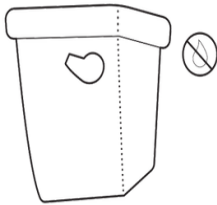

STEP 2

Remove the Toilet Seat

Remove the seat by unscrewing the toilet seat bolts from the hinges.

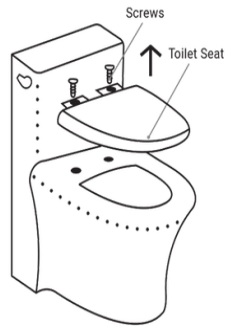

STEP 3

Mount Your Luxe Bidet

Place the bidet on the toilet. The plates are adjusted depending on where the two holes on the back of the toilet seat are.

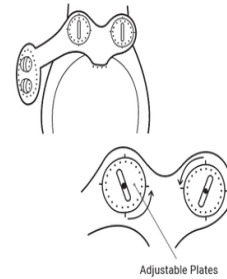

STEP 4

Reattaching Your Toilet Seat

The bidet should now be aligned with the coupling holes. Screw the toilet seat back on the bidet and the toilet.

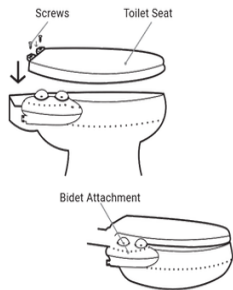

STEP 5

Checking the T-Adapter

Make sure that there is a black rubber washer inserted at the top of the t-adapter. If it is not already there, insert the black rubber washer so it is securely in place as shown in the picture below.

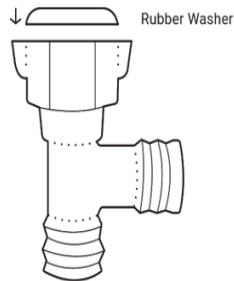

STEP 6

Disconnecting the Water Supply

Make sure you have shut off the toilet tank water supply and flushed the toilet to empty the tank if you have not done so already. Place a towel or bucket underneath the toilet tank connection to catch any residual water. Disconnect the water connection hose from the toilet tank.

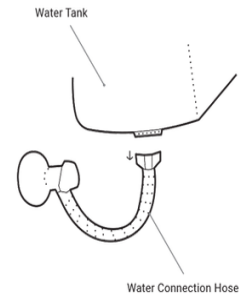

STEP 7

Connecting the Water Supply

Connect the top part of the t-adapter to the toilet tank and connect the bottom part to the toilet water supply valve.

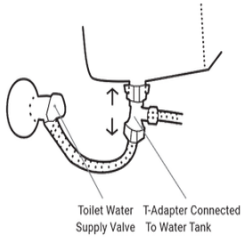

STEP 8

Connecting the Hot Water Metal T-adapter

Make sure that there is a black rubber washer inserted at the top of the t-adapter. If it is not already there, insert the black rubber washer so it is securely in place as shown in the picture below.

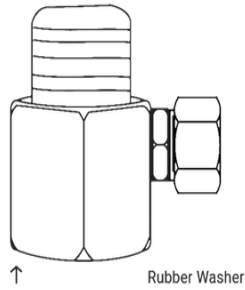

STEP 9

Disconnecting the Water Supply

Make sure you have shut off the toilet tank water supply and flushed the toilet to empty the tank if you have not done so already. Place a towel or bucket underneath the toilet tank connection to catch any residual water. Disconnect the water connection hose from the toilet tank.

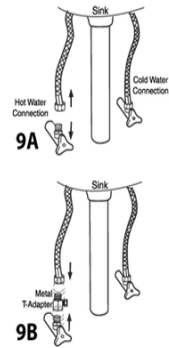

STEP 11

Disconnecting the Water Supply

Make sure you have shut off the toilet tank water supply and flushed the toilet to empty the tank if you have not done so already. Place a towel or bucket underneath the toilet tank connection to catch any residual water. Disconnect the water connection hose from the toilet tank.

STEP 10

Turning On the Toilet Tank Water Supply and the Sink Hot Water Supply

Turn on the toilet tank water supply and the sink hot water supply.

Congratulations! You are ready to use the Luxe Bidet for the first time. Gently turn the water pressure control knob to reach your desired spray pressure.

ASSEMBLED UNIT

